



**JEWELLERY
QUARTER**
ACADEMY

Rapid, Asymptomatic Testing at Jewellery Quarter Academy

Ms. S. Hibbs – Operations Manager / JQA Test Team Leader

Mr. J. Barton – Deputy Headteacher, JQA

0121 729 7220 • enquiry@jewelleryquarter.academy

Headteacher: Greg Williams

 @COREJQAcademy  @COREeducate  @COREeducate

NHS
Test and Trace

Introduction:

- JQA will be offering all asymptomatic (meaning to show no symptoms) students and staff members the opportunity to have COVID-19 tests at the Academy.
- The testing 'workforce' will be made up of our own Academy staff, fully trained external staff and – at times – fully trained and checked volunteers.
- Students and staff will be offered two Lateral Flow Device (LFD) rapid tests 3 to 5 days apart, then one per week thereafter.
- LFD tests give results in around 30 minutes.
- Anyone with a positive result will leave the Academy and take a Polymerase Chain Reaction (PCR) test and follow self-isolation guidelines.



**JEWELLERY
QUARTER**
ACADEMY

Ongoing Routine Testing at JQA:

- Anyone who has been identified as a close contact with someone who has tested positive for COVID-19 can return to the Academy if they agree to be tested for 7 days following their last contact with a positive case (serial contact testing).
- Separate guidance will soon be available for SEND students.

DELIVERING A CORE EDUCATION



Reasons to Take a Test:

- Up to a third of individuals who test positive for COVID-19 have no symptoms and can therefore spread it unknowingly.
- Finding out you are positive when you had no symptoms (asymptomatic) can help save lives and protect the NHS.
- Serial contact testing will mean that many more students can return to education more quickly and continue to make progress more rapidly.
- Tests are safe and accurate (99.8%, according to research).
- In combination with Personal Protective Equipment (PPE), washing hands regularly and social distancing, we must all work together to combat the virus.

What the JQA Testing Site Will Look Like...(photographs of our actual site to follow)

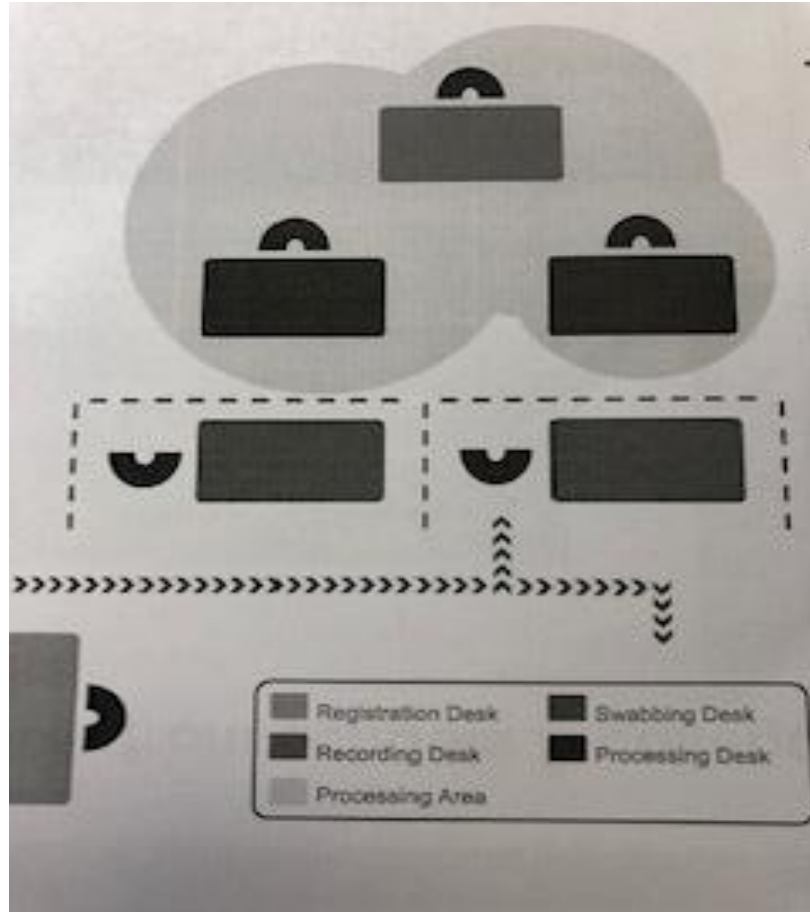

DELIVERING A **CORE** EDUCATION



Obtaining Consent / Permission:

- We need active consent from parents / carers to conduct the tests.
- People who decline to participate in 'serial contact testing' will follow the usual national guidelines and are legally obliged to self-isolate.
- A consent process is underway via telephone for vulnerable and key workers' children and the 'Piota Schools App' for all others.
- Students will self-swab under the supervision of an appropriate member of staff if they have the consent of their parent / carer.
- All data handling and any necessary distribution complies with our rigorous General Data Protection Regulation (GDPR) Policy.



**JEWELLERY
QUARTER
ACADEMY**

Students Self-swabbing:

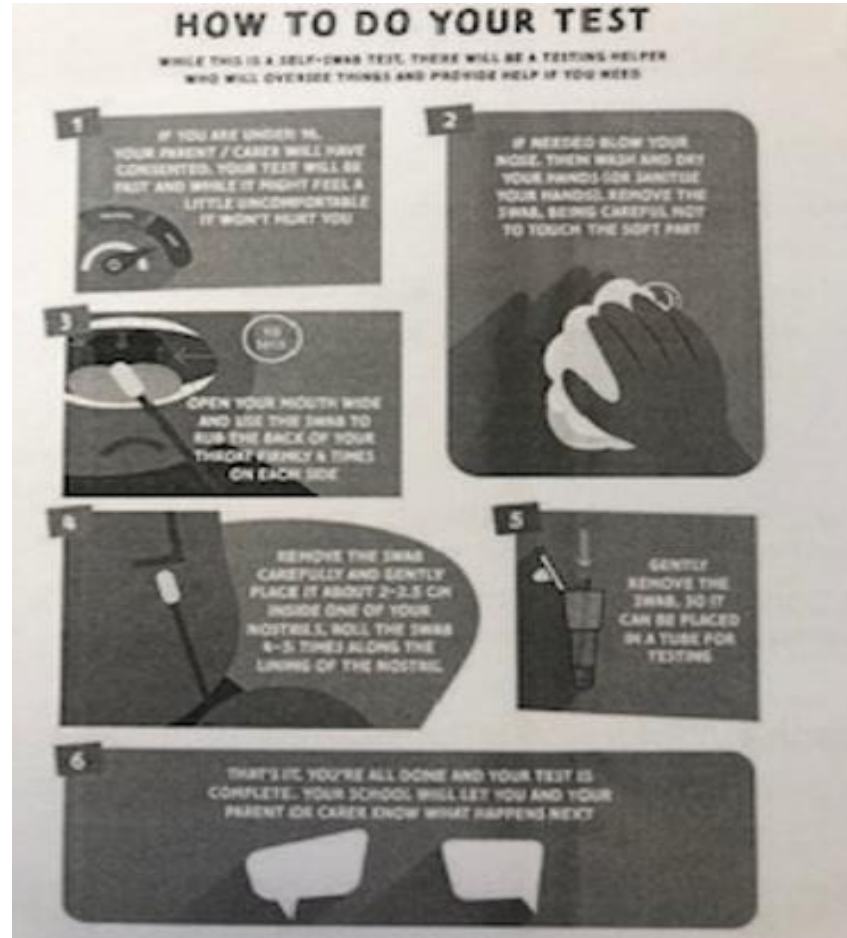

DELIVERING A **CORE** EDUCATION



**JEWELLERY
QUARTER**
ACADEMY

Students Self-swabbing 2

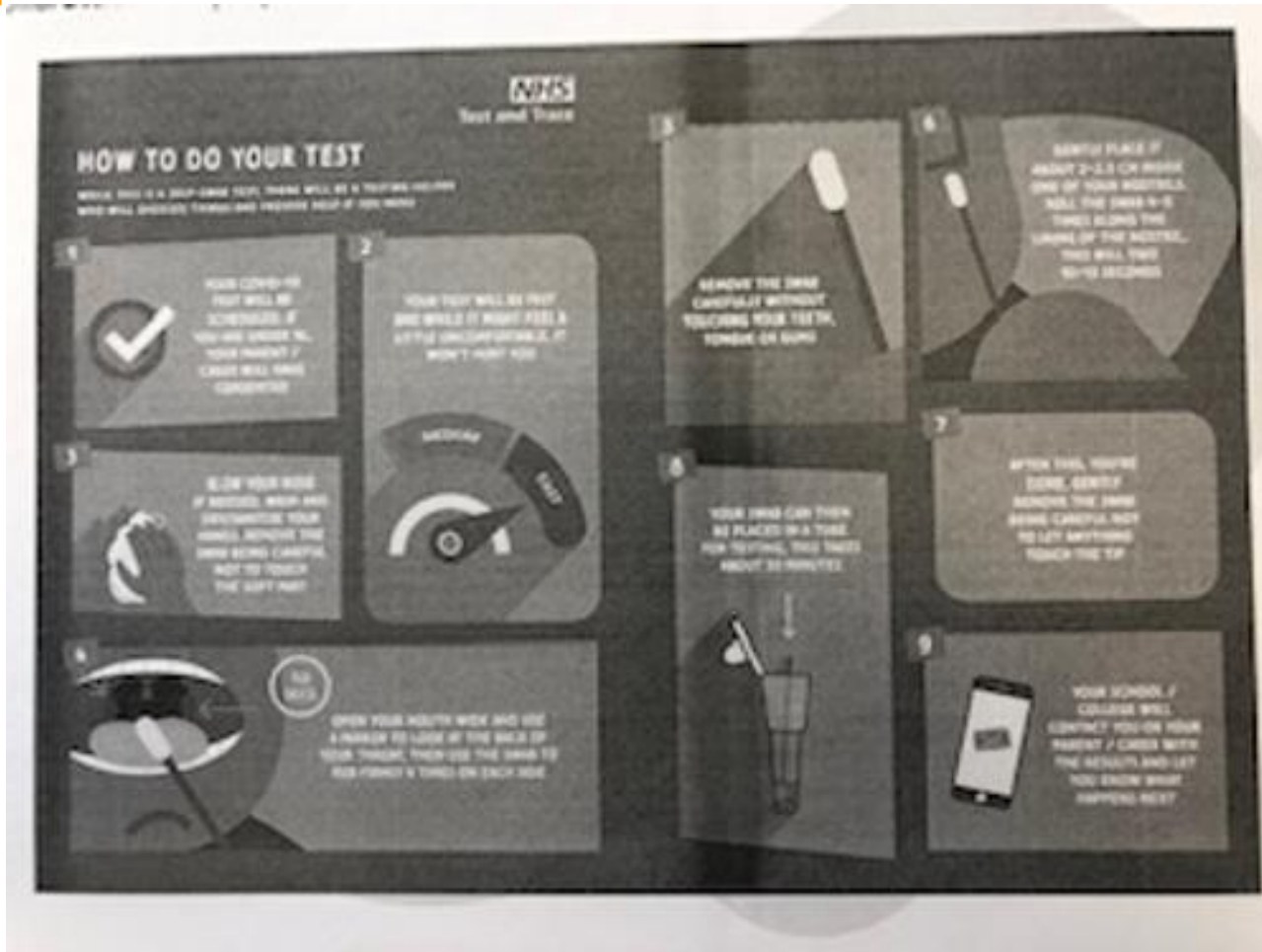

DELIVERING A **CORE** EDUCATION



Any Questions?

sahibbs@jewelleryquarter.academy

DELIVERING A **CORE** EDUCATION